

SUBDIVISIONS CONTAINED IN VOL. E

A. E. BAUMBACH ESTATE	SEC. 13 PAGE 23 SEC. 18 PAGE'S 1, 17, 19, 33, 35, 49, & 51	NORWOOD PARK	SEC. 14 PAGE 35
BAILEY'S 1 ST . ADDITION	SEC. 13 PAGE 33 SEC. 14 PAGE 39	PLEASANT HARBOR SUBD.	SEC. 18 PAGE'S = 3 - 17 - 35 - 51
BLACKMAN'S SUBDIVISION	SEC. 13 PAGE 7	PLEASANT RIDGE ADDITION	SEC. 23 PAGE'S 5 & 7
CLEMONS ADD.	SEC. 13-PG. 33 + SEC. 14-PG. 39	RIDGES ADD.	SEC. 13 PAGE 5+7
CRESTVIEW HEIGHTS ADD.	SEC. 14 PAGE'S 53 & 55	SURREY HEIGHTS 1 ST & 3 RD . ADD.	SEC. 11 PAGE'S 53 & 55
CRESTVIEW HEIGHTS 2 ND . ADD.	SEC. 23 PAGE 5	RIVERSIDE INDUSTRIAL PK.	SEC. 24 PAGE'S 21, 25, 37
DAYTON'S SUBDIVISION	SEC. 13 PAGE 35	RIVERSIDE DEVELOPMENT PK. 1 ST , 2 ND , 3 RD , 4 TH	SEC. 24 PAGE 5, 21
DEER RUN 2 ND ADD.	SEC. 14 PAGE 7	TALLMAN 2 ND ADD.	SEC. 24 P. 17
DIETRICH'S ADDITION	SEC. 13 PAGE 33	TANGLEWOOD HILLS 1 ST . ADD.	SEC. 14 PAGE 17
DODD'S SUBDIVISION	SEC. 13 PAGE'S 19, 21, 23, 37, & 39	TAYLOR'S VALLEY SUBD.	SEC. 13 PAGE 21
DODD'S VALLEY VIEW SUBD.	SEC. 13 PAGE'S 19 & 21	TAYLOR'S VALLEY 2 ND . & 3 RD . SUBD.	SEC. 13 PAGE'S 5 & 21
HICKORY HILL ESTATES 1 ST . ADD.	SEC. 23 PAGE 5	THURWANGERS 1 ST . ADD.	SEC. 13 PAGE'S 35 & 51
" " " 2 ND " " " 3	" " " " " 3	WILLIAMS, RUSSELL J. ADD.	SEC. 14 PAGE 39
" " " 3 RD " " " 3, 5	" " " " " 3, 5		
ISLAND VIEW SUBD. "VACATED"	SEC. 24 PAGE'S 33, 35, 37, & 51		
JAKUBOWSKI'S 1 ST . ADD.	SEC. 13 PAGE'S 5 & 7		
J. J. KRESS'S PLEASANT VIEW SUBD.	SEC. 13 PAGE'S 33 & 35		
KERR'S 1 ST . ADDITION	SEC. 13 PAGE 33		
LEAMER'S RETREAT	SEC. 18 PAGE 35		
LUCILLE HALL'S 1 ST . 2 ND . & 3 RD . ADD.	SEC. 12 PAGE 55		
MARK TWAIN PARK	SEC. 7 PG. 49		
MONROE PHILLIPS FARM	SEC. 18 PAGE'S 3, 19, 35, 51		

VOLUME E
CITY OF

BETTENDORF, IOWA

PART OF SECTIONS 7, 11, 13, 18, 23, 24 & 25 & ALL OF SECTIONS
13 & 14 T 78 N R 4 & 5 E OF 5TH PM
VOLUME G

PLEASANT
VALLEY
TOWNSHIP

VOLUME D

VOLUME C

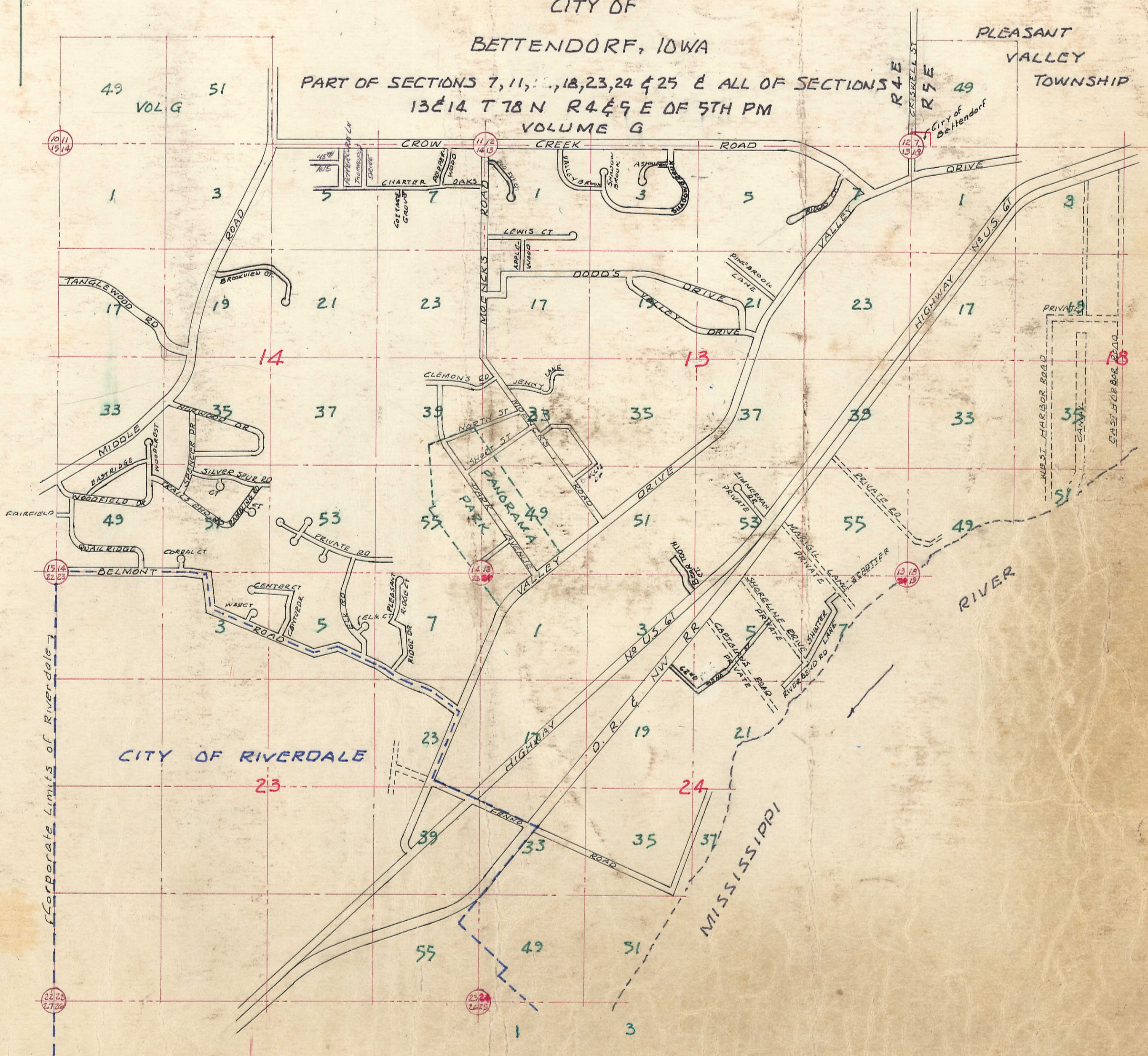

Corporate Limits of Riverdale

R 4 E
R 5 E

127
128

127
128

127
128

127
128

127
128

127
128

127
128

127
128

127
128

127
128

127
128

127
128

127
128

127
128

127
128

127
128

127
128

127
128

127
128

127
128

127
128

127
128

127
128

127
128

127
128

127
128

127
128

127
128

127
128

127
128

127
128

127
128

127
128

127
128

127
128

127
128

127
128

127
128

127
128

127
128